

PORT MELBOURNE 116 Rouse Street

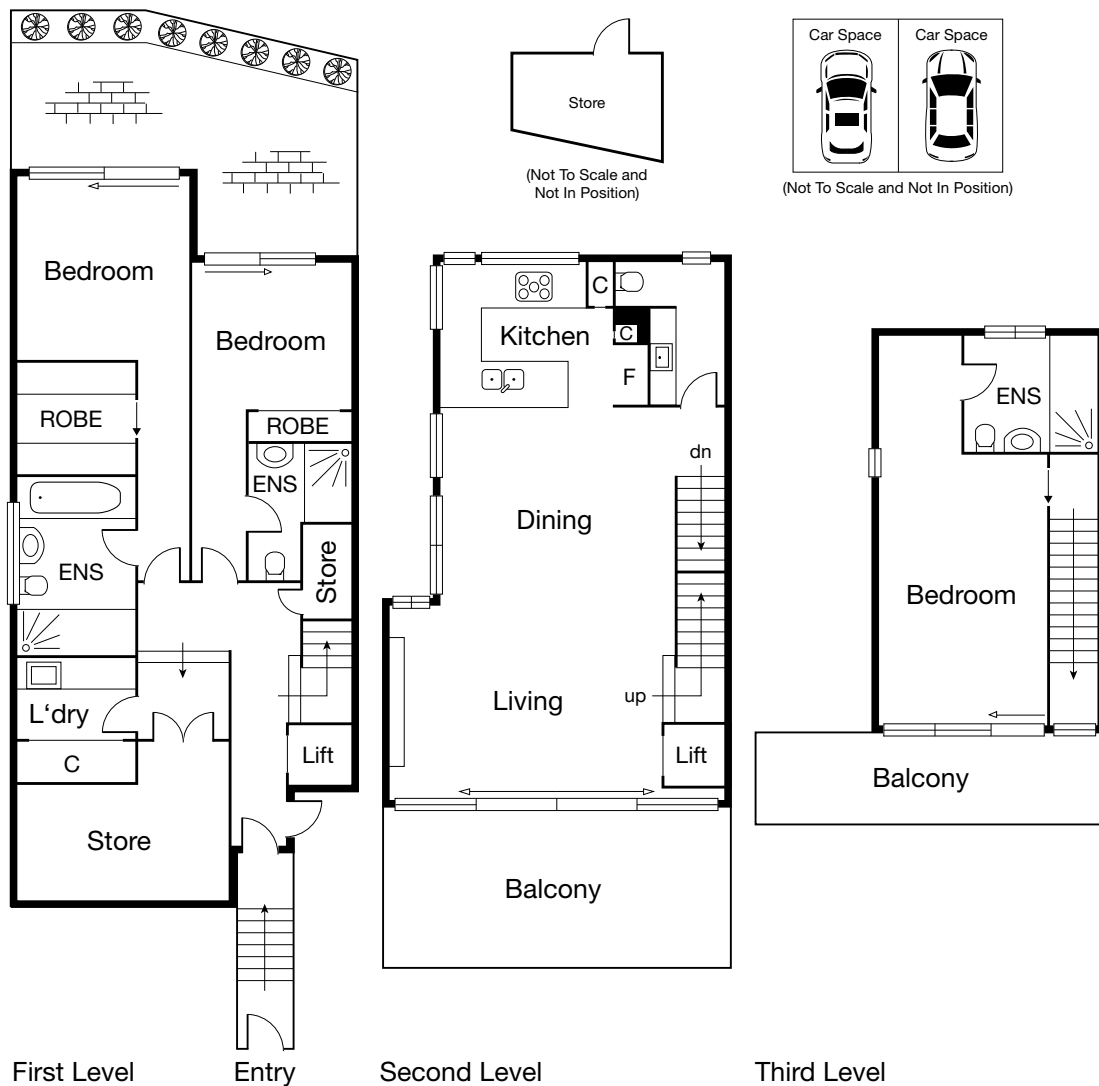

CAYZER

Chisholm & Gamon



116 Rouse Street, Port Melbourne

THREE LEVEL TOWNHOUSE WITH PRIVATE ELEVATOR

- Spanning over three levels with low maintenance living and entertaining in mind
- This light-filled, three bedroom, contemporary residence is immaculately presented
- Featuring its very own elevator, ducted heating and cooling, security system, ample storage, two undercover secure car parks, and storage room

The first floor comprises: Entry, two oversized bedrooms each with access to large northerly orientated courtyard; main with a walk-in robe and ensuite and second bedroom with ensuite and built-in robes. Second level: Superbly functional open plan living/dining area overlooking large entertainer's balcony and kitchen with quality Miele appliances as well as a separate powder room. Third level: Third bedroom complete with ensuite and private balcony.

AUCTION

Auction: Saturday 17 December at 12pm
(if not sold prior)

Inspection: As advertised or by appointment

Contact: Michael Szulc 0417 122 809
Xavier Maher 0418 587 940

Mel Ref: 57 C4



Interactive Floorplan

Every care has been taken to ensure the information contained in this document is accurate. The diagrams/plans are a representation only and are not to scale. Interested parties should seek independent legal advice. Cayzer Real Estate Pty Ltd does not accept any responsibility or liability as a result of the information provided in this document. If any other agent has a current exclusive agency agreement in relation to this property (or business, as the case may be), please disregard this communication.

CAYZER

Albert Park
330 Montague Street
t: 9699 5999 f: 9696 7997

Port Melbourne
310 Bay Street
t: 9646 0812 f: 9645 2646

Cayzer Real Estate Pty Ltd.
cayzer.com.au

CRE20195-116 221116

Chisholm & Gamon

Port Melbourne
1/103 Bay Street
t: 9646 444 f: 9646 3311

chisholmgamon.com.au